

BRIDGE LOCK INSTRUCTIONS

SWITCHING THE CX-5 CBE SIGHT FOR USE WITH THE MATHEWS ARCHERY BRIDGE-LOCK SIGHT MOUNTING SYSTEM

1. Remove the windage adjustment lock knob as shown in figure 1 and 2.

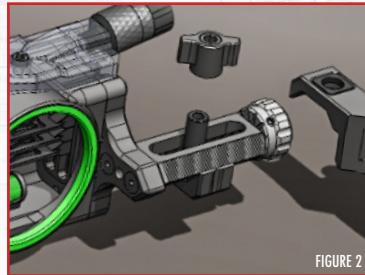
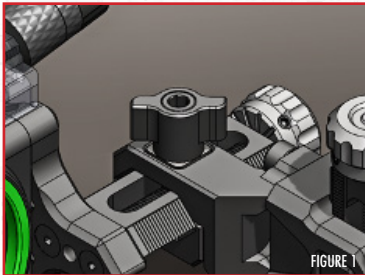

2. Using a 9/64th Allen, remove the two screws that hold the upper windage clamp in place as shown in figure 3 and 4.

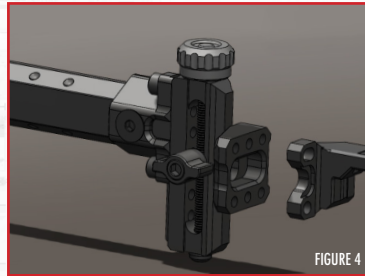
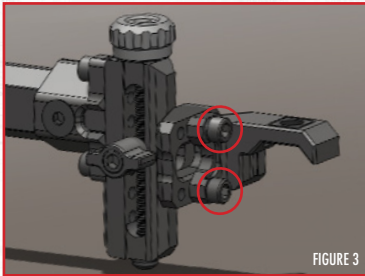

3. Flip the windage clamp over and reinstall the screws in the farthest left set of holes on the elevation mount as shown in Figures 5-7.

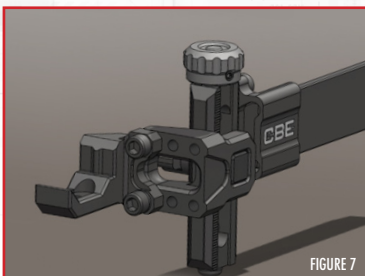
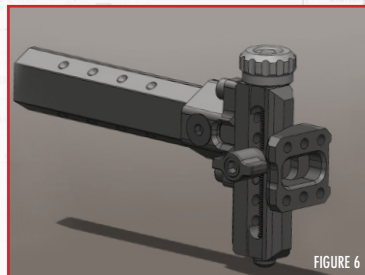
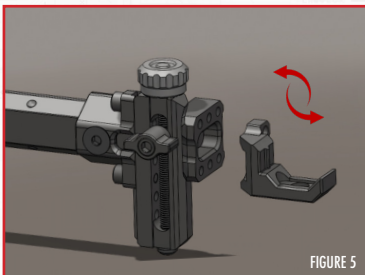

4. Using a 1/16 Allen, remove the two screws that connect the windage bar to the sight housing as shown in Figures 8 and 9.

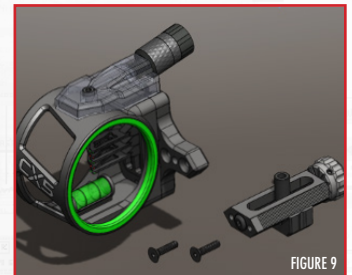
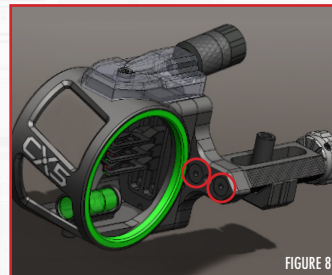

5. Flip the windage bar so that the lower windage clamp is now on top as shown in Figure 10, then reinstall the screws so the assembly looks like Figure 11.

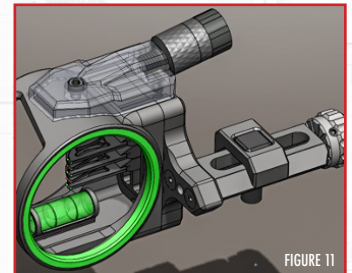
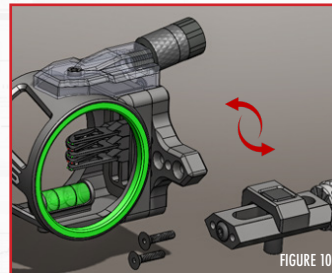

6. Reinstall the windage lock knob on the bottom as shown in Figure 13.

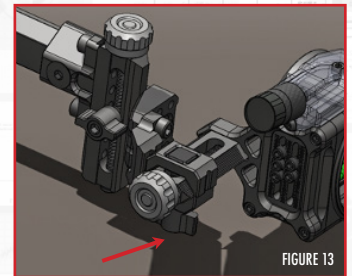
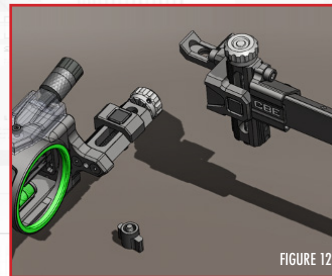

Your CBE CX-5 Sight is now ready to be attached to the Bridge-Lock sight mounting and will have full windage adjustability.

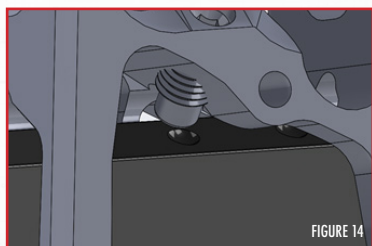

FIGURE 14

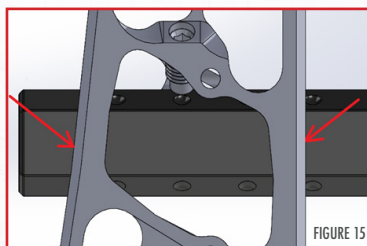

FIGURE 15

7. When the Bridge-Lock compatible set screw is tightened onto the sight bar, you will notice that the set screw does not line up with the indents on the bar as shown in Figure 14. The set screw will still securely lock the bar in place. It is recommended that you mark the bar either at the front or back of the riser (Figure 15) so that it can be easily reinstalled if removed.

**THANK YOU FOR CHOOSING
CUSTOM BOW EQUIPMENT!**



CUSTOM BOW EQUIPMENT

THE OUTDOOR GROUP, LLC

1325 John Street, West Henrietta, NY 14586

(877) 503-5483

www.custombowequipment.com



WARRANTY SERVICES:

IMPORTANT: In the unlikely event that you require service on your product, please contact Customer Service at 1 (877) 503-5483. If necessary, our Customer Service Agents will provide you with a Return Merchandise Authorization (RMA) number and instructions on how to ship the product(s) back. It's important that you contact a Customer Service Agent before returning any item. Please be sure to include your RMA number when returning an item, so that we can identify the return as yours. **Without the RMA, we will not be able to process your return, and your item will not be returned to you.**

LIABILITY DISCLAIMER

The Outdoor Group, LLC is not liable for any personal injury, death, or property damage that may result from your use of this product. The user of this product assumes all risks of property damage or injury to yourself and others that may arise from its use. Use of this product binds the user to this agreement.

PATENT INFORMATION

This product is covered by one or more patents. A complete list of Custom Bow Equipment patents can be found by visiting custombowequipment.com/pages/patents